

V. BHIKSHU SHENDAP Diagram Vb Positions of Panels

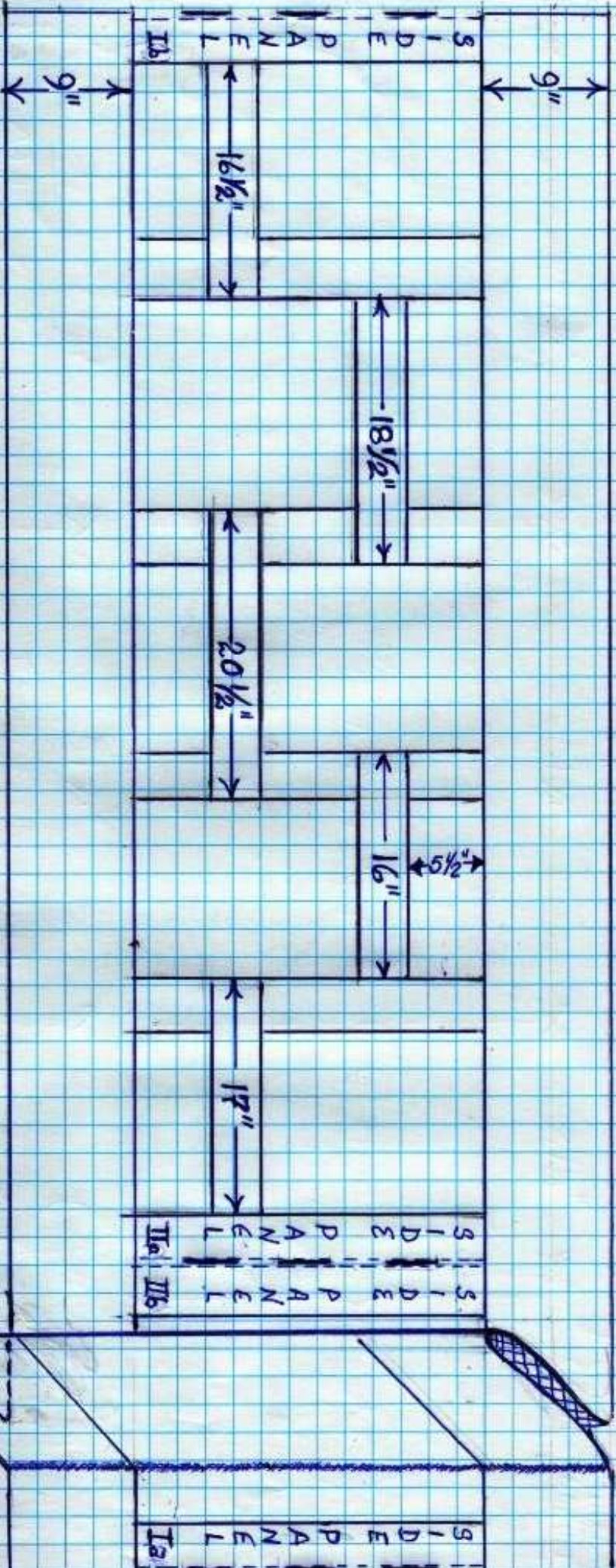

Note ① $\frac{1}{4}$ " borders are pressed under for all Panels.

② Side Panels consist of two panels, left and right.

③ All Panels are cut 4" in width, then with each side decreased by $\frac{3}{4}$ " hem, are a finished width of $3\frac{1}{2}$ ".

④ The total width distance between Side Panels I and II is 33", fabric folded due to paper size.

⑤ All measurements are done to scale (except fold): 0.5 cm = 2 inches [5.08 cm]

V. BHIKSHU SHENDAP DIAGRAM V.a layout and cutting.

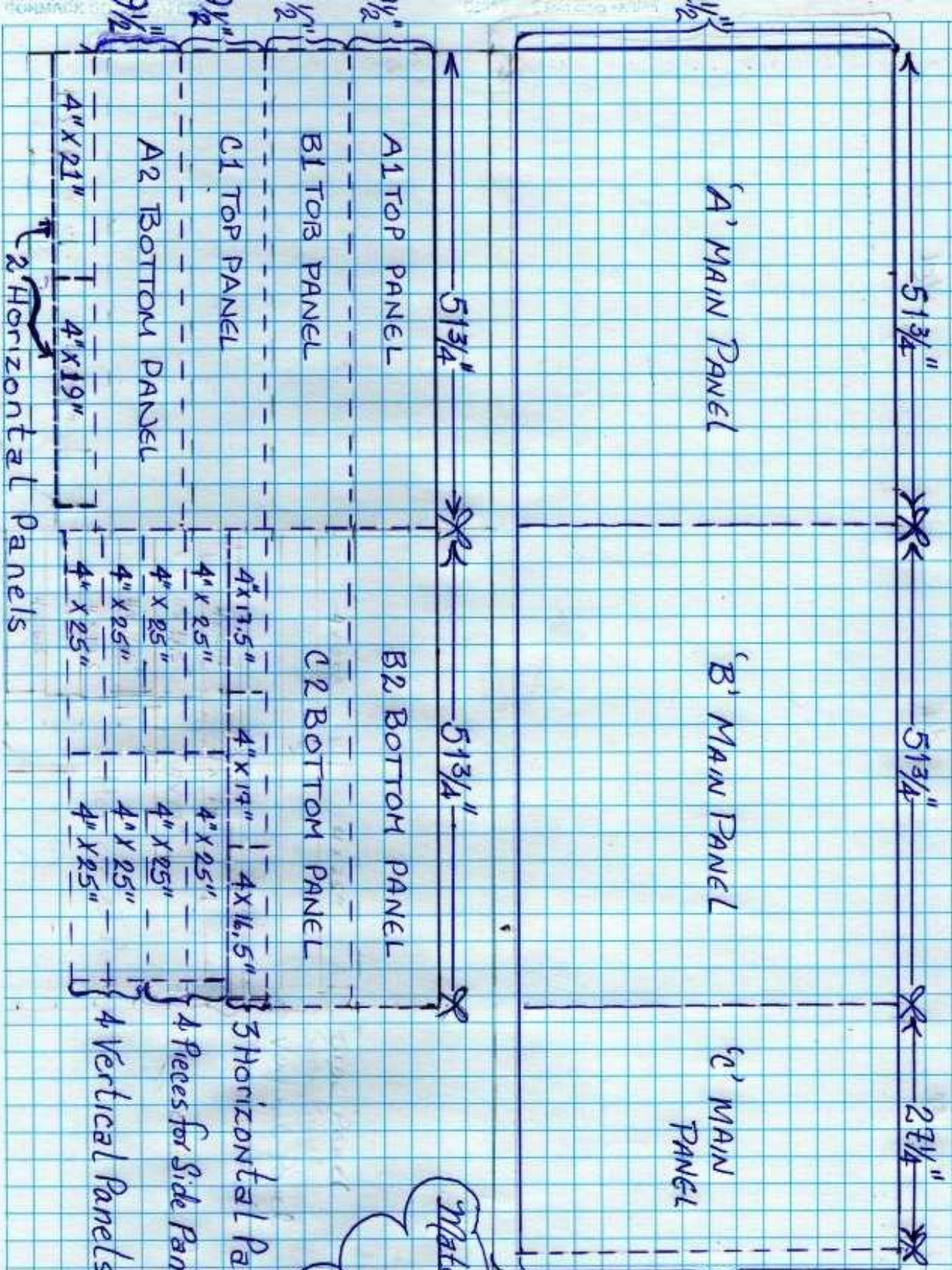

Approximately to scale
 of 0.5cm = 3 inches
 0.5cm = 7.62cm

45" width material
 (cut 42 1/2")

Material Required:
 6 3/4 yards
 of 45 inch wide
 - or -
 6 metres
 of 1.2 metre

3 Horizontal Panels
 4 Pieces for Side Panels
 4 Vertical Panels